

SAE S TO 90S TO HB

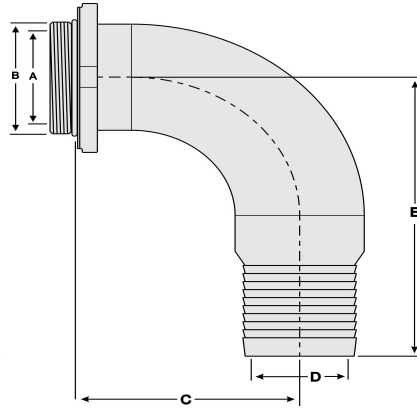

SHORT O-RING SEALED ADAPTER TO SHORT RADIUS 90 DEGREES ELBOW TO HOSE BARB

SAES Split Flange Head to Barb							
Part Number SAE	Port Size	Dimensions IN					Lbs
		A	B	C	D	E	
20SAES-90S-20HB	1 1/4"	1.25	1 5/8 – 12	2.06	1.05	3.25	1.3
20SAES-90S-24HB	1 1/4"	1.25	1 5/8 – 12	2.06	1.29	3.13	1.4
24SAES-90S-20HB	1 1/2"	1.50	1 7/8 – 12	2.35	1.05	4.16	1.7
24SAES-90S-24HB	1 1/2"	1.50	1 7/8 – 12	2.35	1.29	4.16	1.7
24SAES-90S-32HB	1 1/2"	1.50	1 7/8 – 12	2.35	1.75	5.52	2.1
32SAES-90S-24HB	2"	2.00	2 1/2 – 12	2.85	1.29	5.18	2.8
32SAES-90S-32HB	2"	2.00	2 1/2 – 12	2.85	1.75	5.18	2.8
32SAES-90S-40HB	2"	2.00	2 1/2 – 12	2.85	2.25	6.85	3.7
32SAES-90S-48HB	2"	2.00	2 1/2 – 12	2.85	2.66	6.85	4.7
40SAES-90S-32HB	2 1/2"	2.50	3 – 12	3.33	1.75	5.87	4.7
40SAES-90S-40HB	2 1/2"	2.50	3 – 12	3.33	2.25	6.09	4.8
40SAES-90S-48HB	2 1/2"	2.50	3 – 12	3.33	2.66	6.96	5.3
48SAES-90S-32HB	3"	3.00	3 1/2 – 12	3.83	1.75	7.07	6.6
48SAES-90S-40HB	3"	3.00	3 1/2 – 12	3.83	2.25	6.77	6.6
48SAES-90S-48HB	3"	3.00	3 1/2 – 12	3.83	2.66	7.02	6.8
48SAES-90S-64HB	3"	3.00	3 1/2 – 12	3.83	3.63	8.75	8.5
64SAES- 90S-48HB	4"	4.00	4 1/2 – 12	5.10	2.66	8.60	12.2
64SAES- 90S-64HB	4"	4.00	4 1/2 – 12	5.10	3.63	8.94	12.9