

SAE S TO 90L TO HB

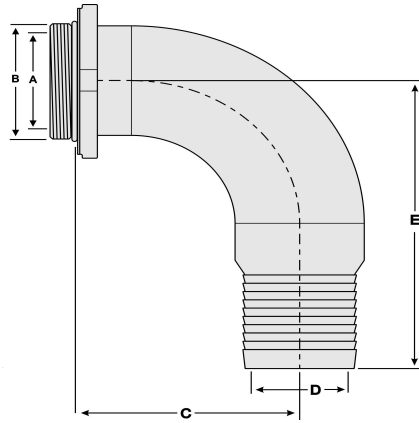

SHORT O-RING SEALED ADAPTER TO LONG RADIUS 90 DEGREES ELBOW TO HOSE BARB

SAES Split Flange Head to Barb							
Part Number SAE	Port Size	Dimensions IN					Lbs
		A	B	C	D	E	
20SAES-90L-20HB	1 1/4"	1.25	1 5/8 – 12	2.69	1.05	4.33	1.5
20SAES-90L-24HB	1 1/4"	1.25	1 5/8 – 12	2.69	1.29	4.38	1.6
24SAES-90L-20HB	1 1/2"	1.50	1 7/8 – 12	3.10	1.05	4.91	2.0
24SAES-90L-24HB	1 1/2"	1.50	1 7/8 – 12	3.10	1.29	4.91	2.0
24SAES-90L-32HB	1 1/2"	1.50	1 7/8 – 12	3.10	1.75	6.28	2.4
32SAES-90L-24HB	2"	2.00	2 ½ – 12	3.85	1.29	6.18	3.1
32SAES-90L-32HB	2"	2.00	2 ½ – 12	3.85	1.75	6.18	3.1
32SAES-90L-40HB	2"	2.00	2 ½ – 12	3.85	2.25	7.85	4.0
32SAES-90L-48HB	2"	2.00	2 ½ – 12	3.85	2.66	7.85	5.0
40SAES-90L-32HB	2 1/2"	2.50	3 – 12	4.58	1.75	7.13	5.4
40SAES-90L-40HB	2 1/2"	2.50	3 – 12	4.58	2.25	7.35	5.5
40SAES-90L-48HB	2 1/2"	2.50	3 – 12	4.58	2.66	8.18	6.0
48SAES-90L-32HB	3"	3.00	3 ½ – 12	5.38	1.75	8.57	8.0
48SAES-90L-40HB	3"	3.00	3 ½ – 12	5.38	2.25	8.27	8.0
48SAES-90L-48HB	3"	3.00	3 ½ – 12	5.38	2.66	8.52	8.2
48SAES-90L-64HB	3"	3.00	3 ½ – 12	5.38	3.63	10.24	9.9
64SAES- 90L-48HB	4"	4.00	4 ½ – 12	7.10	2.66	10.62	14.5
64SAES- 90L-64HB	4"	4.00	4 ½ – 12	7.10	3.63	10.96	15.2