

SAE 45 TO HB

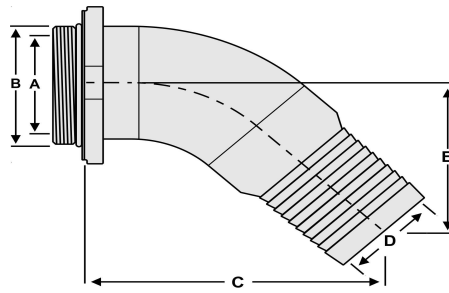

O-RING SEALED ADAPTER TO HOSE BARB

SAE Head to Barb						
Part Number	Port Size	Dimensions IN				Lbs
		A	B	C	D	
SAE						
20SAE-45-20HB	1 1/4"	1.25	1 5/8 – 12	4.60	1.05	1.3
20SAE-45-24HB	1 1/4"	1.25	1 5/8 – 12	4.60	1.29	1.4
24SAE-45-20HB	1 1/2"	1.50	1 7/8 – 12	5.12	1.05	1.8
24SAE-45-24HB	1 1/2"	1.50	1 7/8 – 12	5.12	1.29	1.8
24SAE-45-32HB	1 1/2"	1.50	1 7/8 – 12	6.05	1.75	2.2
32SAE-45-24HB	2"	2.00	2 1/2 – 12	5.75	1.29	2.8
32SAE-45-32HB	2"	2.00	2 1/2 – 12	5.75	1.75	2.8
32SAE-45-40HB	2"	2.00	2 1/2 – 12	7.02	2.25	3.7
32SAE-45-48HB	2"	2.00	2 1/2 – 12	7.02	2.66	4.6
40SAE-45-32HB	2 1/2"	2.50	3 – 12	6.67	1.75	4.7
40SAE-45-40HB	2 1/2"	2.50	3 – 12	6.78	2.25	4.7
40SAE-45-48HB	2 1/2"	2.50	3 – 12	7.25	2.66	5.2
48SAE-45-32HB	3"	3.00	3 1/2 – 12	7.18	1.75	6.2
48SAE-45-40HB	3"	3.00	3 1/2 – 12	7.02	2.25	6.2
48SAE-45-48HB	3"	3.00	3 1/2 – 12	7.15	2.66	6.4
48SAE-45-64HB	3"	3.00	3 1/2 – 12	8.55	3.63	8.1
64SAE-45-48HB	4"	4.00	4 1/2 – 12	8.93	2.66	10.4
64SAE-45-64HB	4"	4.00	4 1/2 – 12	9.10	3.63	11.1