

C61 STRAIGHT TO HB

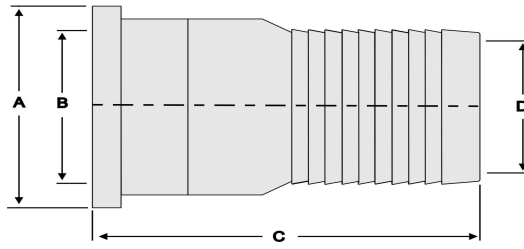

O-RING SEALED ADAPTER TO HOSE BARB

SAE Split Flange Head to Barb							
Part Number	Port Size	Dimensions IN				Lbs	Split Flange Kit (sold separately)
		A	B	C	D		
SAE C61							
20C61-00-20HB	1 1/4"	2.00	1.25	2.88	1.05	0.5	SF20
20C61-00-24HB	1 1/4"	2.00	1.25	2.75	1.29	0.5	SF20
24C61-00-20HB	1 1/2"	2.38	1.50	3.91	1.05	0.9	SF24
24C61-00-24HB	1 1/2"	2.38	1.50	3.91	1.29	0.9	SF24
24C61-00-32HB	1 1/2"	2.38	1.50	5.27	1.75	1.3	SF24
32C61-00-24HB	2"	2.81	2.00	4.43	1.29	1.2	SF32
32C61-00-32HB	2"	2.81	2.00	4.43	1.75	1.2	SF32
32C61-00-40HB	2"	2.81	2.00	6.10	2.21	2.1	SF32
32C61-00-48HB	2"	2.81	2.00	6.12	2.66	3.0	SF32
40C61-00-32HB	2 1/2"	3.38	2.50	4.37	1.75	1.7	SF40
40C61-00-40HB	2 1/2"	3.38	2.50	4.59	2.25	1.8	SF40
40C61-00-48HB	2 1/2"	3.38	2.50	5.46	2.66	2.4	SF40
48C61-00-32HB	3"	4.00	3.00	5.95	1.75	3.0	SF48
48C61-00-40HB	3"	4.00	3.00	5.65	2.25	3.0	SF48
48C61-00-48HB	3"	4.00	3.00	5.90	2.66	3.2	SF48
48C61-00-64HB	3"	4.00	3.00	7.63	3.63	4.9	SF48
64C61-00-48HB	4"	5.00	4.00	6.48	2.66	4.8	SF64
64C61-00-64HB	4"	5.00	4.00	6.82	3.63	5.5	SF64